

Product Information Sheet



Railway Signaling

	Type RS6836 12V 20/20W BA20d
	Ordering – No. 46836
Product Description	Signaling Lamp
Features	Double Filament
Applications	Railway Signal

Technical Details

Type	RS6836
Rated Voltage (V)	12
Wattage (W) (at 1,7A) (MF/AF)	max. 22,0 / 22,0
Luminous Flux (lm) (at 1,7A) (MF/AF)	250 / 250
Average Lifetime (h) (at 1,7A) (MF/AF)	8800 / 200
Base	BA20d
Maximum Overall Length (mm)	max. 67,0
Bulb Diameter (mm)	max. 36,0
Light Center (mm)	MF 29,6 ± 0,15 AF 29,6 ± 0,5
Filament Distance (mm) MF-AF	2,5 ± 0,5
Packaging Configuration	200 pcs.
Environmental Remark	Product don't contain lead or mercury and is conform with Directive 2011/65/EC "Restriction of the use of certain hazardous substances in electrical and electronic equipment".

Drawing (in mm)

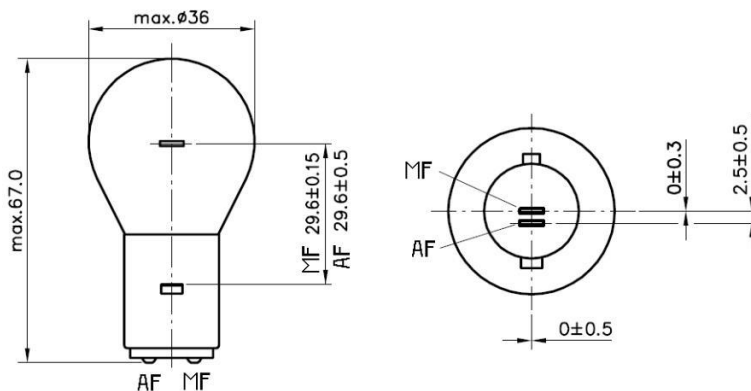

ITT 360
WIR MACHEN VERTRIEB

www.german-lamps.eu

www.ventas-focos-itt360.com

